

KEYS:	
	WIND DIRECTIONS
	TREES TO BE REMOVED
	PRIVATE COURTYARDS
	POTENTIAL NOISE IMPACT TRAFFIC & NEIGHBOURING
	SITE ACCESS
	VIEWS
	NORTHERN SUNLIGHT

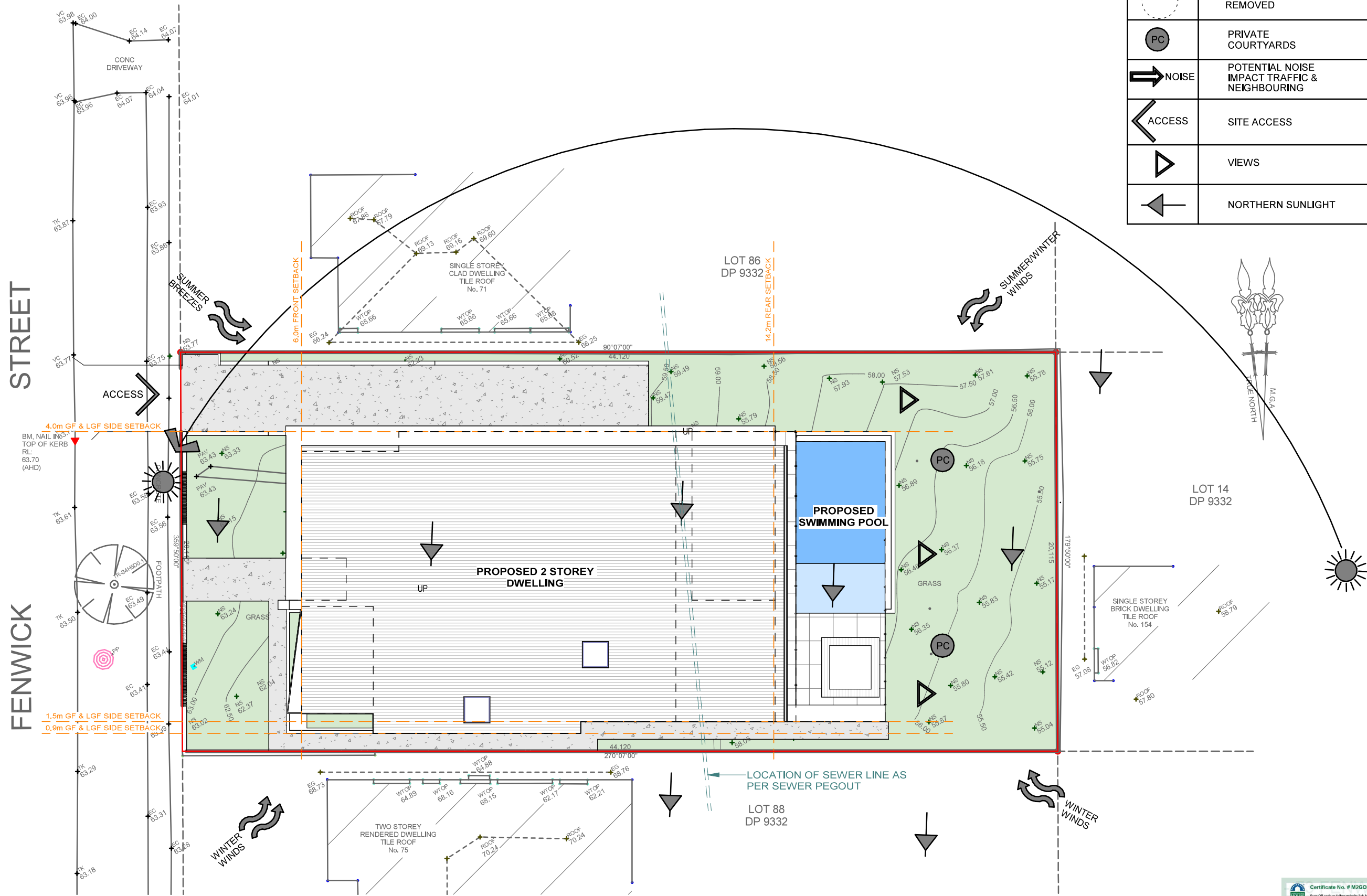

1 SITE PLAN & ROOF PLAN, SITE ANALYSIS PLAN  
1 : 200



This drawing can only be used for the specified project and address. architectural drawings indicate design intent ONLY. licensed builder is to ensure that all construction is in accordance with all relevant AUSTRALIAN STANDARDS and BUILDING CODES. licensed builder is to also ensure that the plans meet the site specifications. this drawing is to be used in accordance with its purpose of issue 'ONLY' no responsibility will be accepted for the improper use of this drawing. DANDACHU DESIGN STUDIO will not be liable for any 'ERRORS' miscalculations, misinterpretations of any nature and will not be held liable for any claims, requisitions and liabilities arising from any future claims. Accepting this drawing will be considered as your form of acceptance of the content of the drawings. BY accepting this drawing you also agree that you have carried out your site survey and dimensions of the site to which the drawings relate and will not hold DANDACHU DESIGN STUDIO liable for any errors or miscalculations that may arise, before, during or after construction.

REV	DATE	DESCRIPTION	BY
A	OCT 24	DA SUBMISSION	MD

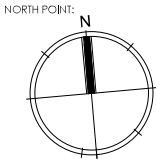

CLIENT:  
**NUCON CONSTRUCTION**

DRAWING TITLE:  
**SITE PLAN & SITE ANALYSIS PLAN**

JOB NUMBER:	DWG NUMBER:	ORIGINAL SIZE:
24001	A01.02	A3
DRAWN BY:	REV DATE:	REV:
MD	JAN 24	A
CHECKED BY:	SCALE:	AS SHOWN
MD		

JOB DESCRIPTION:  
**PROPOSED 2 STOREY DWELLING**

ADDRESS:  
**73 FENWICK STREET, BANKSTOWN  
LOT 87 DP 9332**

